

efector100

Inductive proximity switches

IIC201

IIB3022-BPKG/M/US
Metal thread M30 x 1.5
Plug and socket

Increased sensing range
gold-plated contacts

Sensing range 22mm [nf]
non-flush mountable

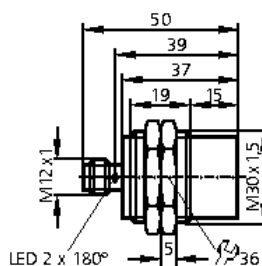
**Electrical design****Output****DC PNP****normally open**

Operating voltage [V]

10...36 DC

Current rating [mA]

100

Short-circuit protection

pulsed

Reverse polarity protection

yes

Overload protection

yes

Voltage drop [V]

< 2.5

Current consumption [mA]

< 10 (24 V)

Real sensing range [mm]

22 ± 10 %

Operating distance [mm]

0...17.82

Switch-point drift [% / Sr]

-10...10

Hysteresis [% / Sr]

3...15

Switching frequency [Hz]

100

Correction factors

mild steel = 1 / stainless steel approx. 0.7 / brass approx. 0.5 / Al approx. 0.4 /
Cu approx. 0.3

Operating temperature [°C]

-25...70

Protection

IP 68 *)

EMC

IEC 1000-4-2 / EN 61000-4-2: 4 kV / CD / 8 kV AD

IEC 1000-4-3 / EN 61000-4-3: 10 V/m, 80...1000 MHz

IEC 1000-4-4 / EN 61000-4-4: 2 kV

IEC 1000-4-6 / EN 61000-4-6: 10 V / 0.15...80 MHz

EN 55011: class B

Housing material

brass Optalloy-plated; active face: LCP

Function display

Switching status LED

yellow (4 x 90°)

Connection

M12 connector; gold-plated contacts

Wiring

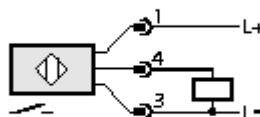

Remarks

*) "Coolant"

Accessories (included)

2 lock nuts

ifm electronic gmbh · Teichstraße 4 · D-45127
Essen

— We reserve the right to make technical alterations without prior notice. — GB - IIC201 — 06.03.2003