



# efector200

Photoelectric sensors

## OGP500

Retro-reflective sensor  
OGP-FPKG/US  
Threaded type M18 x 1  
Plug and socket

Polarisation filter

Sensing range 0,03 ... 5m  
(Prismatic reflector Ø 80  
(E20005))  
adjustable

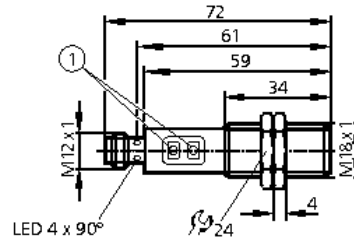

1: Programming buttons

### Electrical design

#### Output

### DC PNP

light-on / dark-on programmable via push button

Light spot diameter [mm]

200 (RW = 5000 mm)

Operating voltage [V]

10...36 DC

Current rating [mA]

200 (...60 °C) / 150 (...80 °C)

Short-circuit protection

pulsed

Reverse polarity protection

yes

Overload protection

yes

Voltage drop [V]

< 2.5

Current consumption [mA]

20

Switching frequency [Hz]

2000

Type of light

Transmitter red light 624 nm

Operating temperature [°C]

-25...80

Protection

IP 67

EMC

EN 60947-5-2

Housing material

stainless steel (316S12); PA; LCP; EPDM; TPU

Material lens

PMMA

Function display

Switching status LED

yellow

Connection

M12 connector

Wiring

